

- **Owner:**
The Pennsylvania State University
- **Services:**
Structural Engineering
- **Size:**
6,200 SF
- **Construction Cost:**
\$2,000,000
- **Year Completed:**
2021

Leonhard Building Knowledge Commons Renovation



The Pennsylvania State University, University Park, PA

Stahl Sheaffer provided structural engineering services through design and construction as part of the project team for the Penn State Leonhard Commons renovation. This facility is the hub for the Harold and Inge Marcus Department of Industrial and Manufacturing Engineering and their students within the College of Engineering. The goal of the renovation was to create a space for students to interface with each other, faculty, and industry professionals outside the classroom.



Exterior renovations included the creation of a new entry vestibule and conference room, as well as the addition of a dock leveler and new overhead door. Stahl Sheaffer provided structural engineering to enclose a bay under an existing roof overhang adjacent to the current main entry vestibule. This created a new entrance so that the existing vestibule could be converted into a conference room. The existing dock door was enlarged with new steel lintel and jamb columns, and a new dock leveler was cast into a concrete expansion of the existing loading dock to allow for larger pieces of equipment and material to move freely in and out of the Factory for Advanced Manufacturing Education Lab.

Interior renovations provided new student study areas, a computer classroom, group study rooms, and an office space. Stahl Sheaffer assisted with cold formed metal stud framing design and detailing for the interior rework.

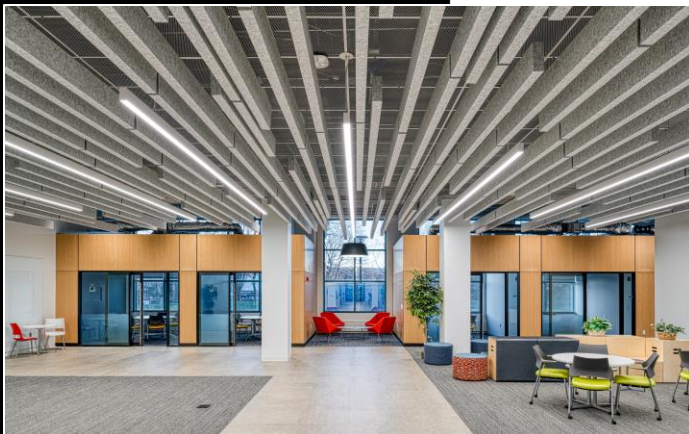

Photos courtesy of Poole Anderson Construction