

- **Owner:**  
Fairleigh Dickinson University
- **Services:**  
Structural Engineering Design
- **Year Completed:**  
Currently under Construction

# New Baseball Stadium Design



## Fairleigh Dickinson University, Madison, NJ

Stahl Sheaffer performed structural engineering and construction administration tasks to support the architect for the design of a new two-story concrete masonry and steel framed pressbox structure and concrete masonry and steel framed dugouts. The roof structures for both press box and dugouts consist of wood framed roof joists and are supported by shallow foundations. Foundations designs were also completed for a new scoreboard structure.

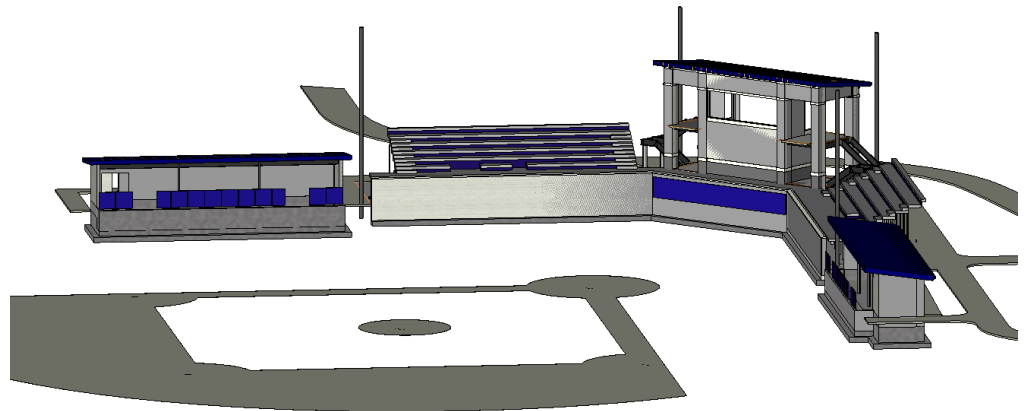

*Fairleigh Dickinson Baseball Stadium Facilities designed in Revit.*